

42-0530 Removal and installation of parking brake shoes

Preceding work:
Remove brake discs on rear axle (42-0228).

Operation no. of operation texts and work units or standard texts
and flat rates:
42-3301, 42-3302

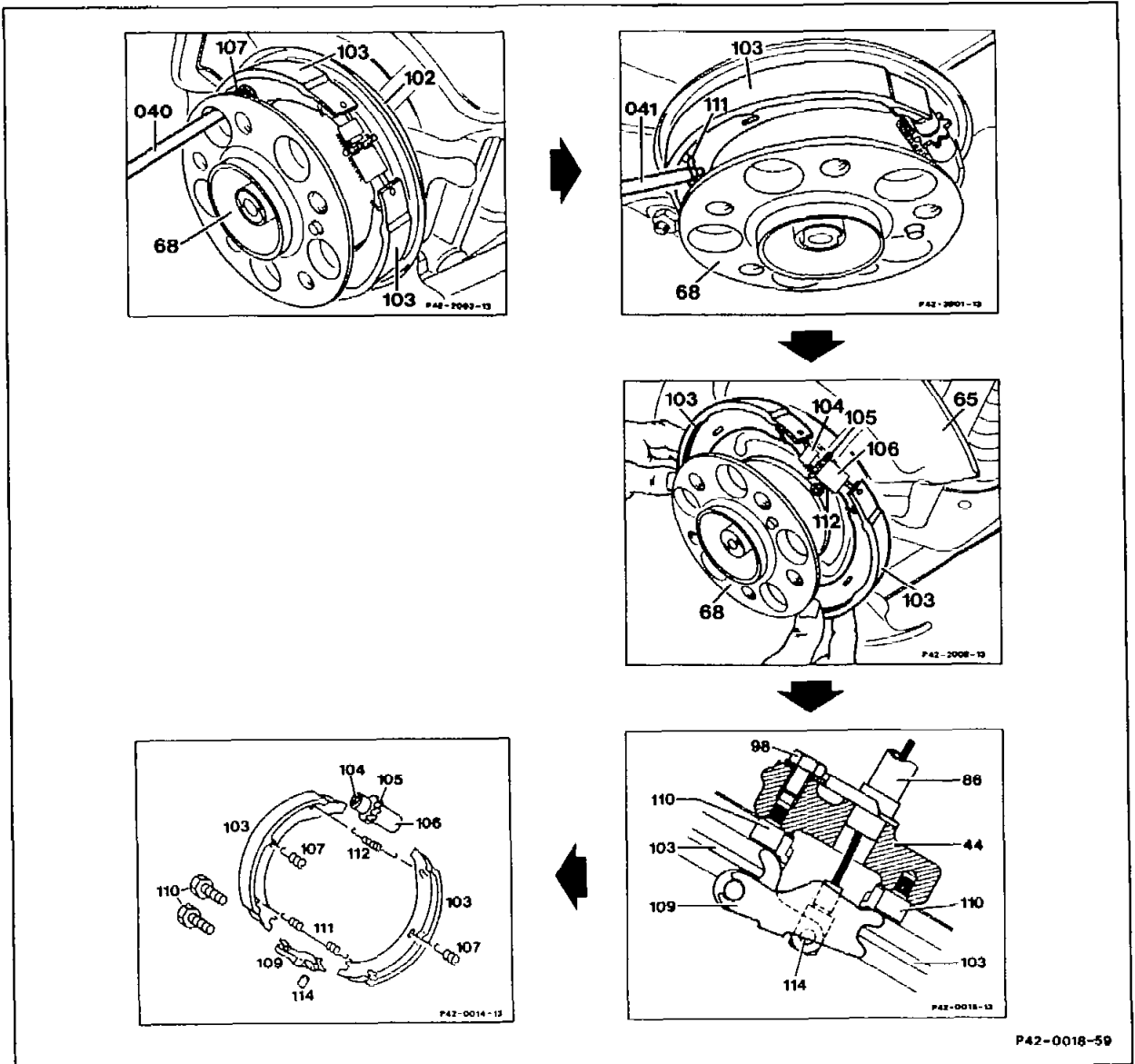

Rear axle shaft flange (68) turn so that a hole points to the spring (107).



If brake shoes (103) are burnt, it is **absolutely essential** that the return springs (107, 111, 112) and ventilated brake discs are replaced.

Spring (107)	compress slightly with tool (040) 112 589 09 61 00, turn approx. 90° and unhook spring (107), hook in. Remove/install spring (107) on other brake shoe (103) in the same manner. When installing check spring (107), replace if required and ensure that springs are correctly seated.
Return spring (111)	unhook from brake shoe (103) with tool (041) 116 589 01 62 00, hook in. When installing hook return spring (111) into small eye in brake shoes (103).
Brake shoes (103)	spread apart so that they can be removed over the rear axle shaft flange (68). When installing insert adjustment device (104–106) into both brake shoes (103) so that the adjuster (105) points toward the front.
Return spring (112)	unhook from brake shoes (103), hook in , and remove adjustment device (104-106). Before installing, coat thread on thrust piece (104) and cylindrical portion of adjuster (105) with specified lubricant, Molykote paste U, Molykote paste G rapid or Liqui-Moly paste 36. Reassemble adjustment device, turn back completely and install with thrust piece (104) toward front of vehicle.
Pin (114)	press out of spreader lock (109) and remove spreader lock (109) from brake control cable (86). Before installation, coat all bearing and sliding surfaces on spreader lock (109) with specified lubricant, Molykote paste U, Molykote paste G rapid or Liqui-Moly paste 36. Fasten brake cable (86) with pin (114) to spreader lock (109). Then press spreader lock against cover ring (102). Observe installation position (see figure).
Parking brake	adjust after installing brake discs (42–0540).

Special tools

